

MEIGSVILLE TOWNSHIP SECTION 34 R11 TWP 10 MORGAN COUNTY, OHIO

PIN	Owner	VOL	PAG	LegalDescr	Acres	Survey_Ref
120-005-810-1	HACKNEY RICHARD A & BRENDA J M	OR233	1871	R11 T10 S00 FR 34	0.803	MIG-0310.pdf
120-008-620-0	KRIGBAUM KENNETH C & KARLA	OR147	183	R11 T10 S00 FR 34	2.351	NoSurvey.pdf
120-004-970-0	KRIGBAUM KENNETH C & KARLA J	OR230	722	R11 T10 S00 FR 34	0.74	MIG-0199.pdf
120-005-800-0	MURPHY JAMES E & CASSIE L	OR168	316	R11 T10 S00 FR 34	22.75	NoSurvey.pdf
120-005-810-0	MURPHY JAMES E & CASSIE L	OR168	316	R11 T10 S00 FR 34	20.947	NoSurvey.pdf
120-005-430-0	MURPHY MARK E & BRENDA J	D.V 196	771	R11 T10 S00 FR 34	37.37	NoSurvey.pdf
120-006-980-0	PONCHAK GARY D	OR141	570	R11 T10 S00 FR 34	5	NoSurvey.pdf
120-004-350-0	SHIFLETT MARGARET JOHNSON & RO	OR222	2864	R11 T10 S00 FR 34	47.48	NoSurvey.pdf
120-004-360-0	SHIFLETT MARGARET JOHNSON & RO	OR222	2867	R11 T10 S00 FR 34	14.27	NoSurvey.pdf
120-008-600-0	WEBB HAROLD G & JUANITA	D.V 126	65	R11 T10 S00 FR 34	1	NoSurvey.pdf
120-008-620-1	WEBB JOHN & TRINA	OR22	300	R11 T10 S00 FR 34	0.81	MIG-0198.pdf

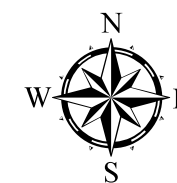

Boundaries			
	Hydro		Section
	Roads		Lot
	County		Parcel
	Township		ROW

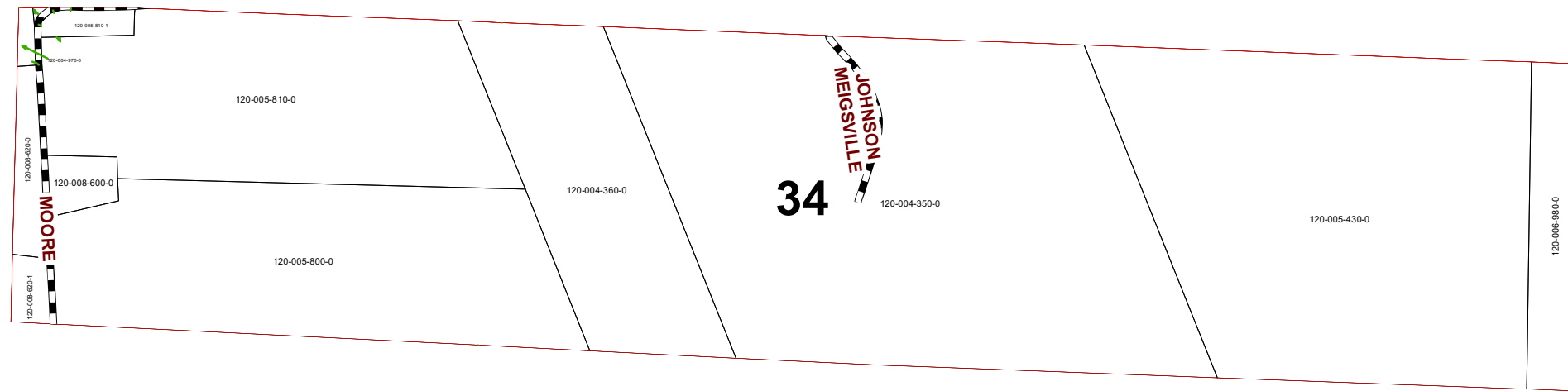

Disclaimer: The information that these maps contains is for reference purposes only. Please bring any erros to the attention of the Engineer's Office staff. Thank you